



Project:	Type:
Prepared By:	Date:

Driver Info		LED Info	
Type	Constant Current	Watts	36W
120V	0.30A	Color Temp	3000K/3500K/4000K/5000K
208V	0.18A	Color Accuracy	84 CRI
240V	0.15A	L70 Lifespan	100,000 Hours
277V	0.13A	Lumens	2888-6603 lm
Input Watts	23-48.6W	Efficacy	125.6-135.9 lm/W

Technical Specifications

Field Adjustability

Field Adjustable:

Field Adjustable Light Output:
48W/36W/24W (factory default 36W)
Color temperature (selectable by 5000K, 4000K, 3500K and 3000K)

Compliance

UL Listed:

Suitable for damp locations

DLC Listed:

This product is on the Design Lights Consortium (DLC) Qualified Products List and is eligible for rebates from DLC Member Utilities. Designed to meet DLC 5.1 requirements.
DLC Product Code: S-6KWZJ1

Electrical

Driver:

24W: Constant Current, Class 2, 120-277V, 50/60Hz, 120V: 0.20A, 208V: 0.12A, 240V: 0.10A, 277V: 0.09A
36W: Constant Current, Class 2, 120-277V, 50/60Hz, 120V: 0.30A, 208V: 0.18A, 240V: 0.15A, 277V: 0.13A
48W: Constant Current, Class 2, 120-277V, 50/60Hz, 120V: 0.40A, 208V: 0.23A, 240V: 0.20A, 277V: 0.18A

Dimming Driver:

Driver includes dimming control wiring for 0-10V dimming systems. Requires separate 0-10V DC dimming circuit. Dims down to 5%.

THD:

6.6% at 120V, 11.4% at 277V

Power Factor:

99.6% at 120V, 96.9% at 277V

Surge Protection:

1-2kV

Battery Backup:

Battery backup will operate the fixture for 90 minutes if power fails. Wired for 120-277V.

Battery Backup Light Loss Factor:

24W: 0.73
36W: 0.48
48W: 0.38

Performance

Lifespan:

100,000-Hour LED lifespan based on IES LM-80 results and TM-21 calculations

Wattage Equivalency:

24W: Replaces up to (1) F32T8
36W: Replaces up to (2) F32T8
48W: Replaces up to (2) F32T8

LED Characteristics

LEDs:

Long-life, high-efficiency, surface-mount LEDs

Color Consistency:

4-step MacAdam Ellipse binning to achieve consistent fixture-to-fixture color

Color Uniformity:

RAB's range of Correlated Color Temperature follows the guidelines of the American National Standard for Specifications for the Chromaticity of Solid State Lighting (SSL) Products, ANSI C78.377-2017.

Construction

Cold Weather Starting:

The minimum starting temperature is -20°C (-4°F)

Maximum Ambient Temperature:

Suitable for use in up to 50°C (122°F)

Housing:

Cold Rolled Carbon Steel Sheets and Strip (SPCC)

Lens:

Diffused Polymethyl Methacrylate (PMMA)

Technical Specifications (continued)

Mounting:

Comes standard with two mounting accessories: aircraft cable for secure, suspended mounts and a stainless bracket for easy mounting to junction boxes.

Finish:

Formulated for high durability and long-lasting color

Green Technology:

Mercury and UV free. RoHS-compliant components.

Other

Lighting Pattern:

70% downlight, 30% uplight

Accessories:

Fixture to fixture connector: [TOMO CONNECT](#)

Warranty:

RAB warrants that our LED products will be free from defects in materials and workmanship for a period of five (5) years from the date of delivery to the end user, including coverage of light output, color stability, driver performance and fixture finish. RAB's warranty is subject to all terms and conditions found at rablighting.com/warranty.

Buy American Act Compliance:

RAB values USA manufacturing! Upon request, RAB may be able to manufacture this product to be compliant with the Buy American Act (BAA). Please contact customer service to request a quote for the product to be made BAA compliant.

Dimensions

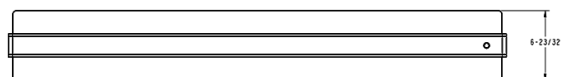

Features

- 0-10V dimming
- 100,000-Hour LED lifespan
- 5-Year, No-Compromise Warranty

Ordering Matrix

Family	Length (Wattages)	Color Temp	Finish	Voltage	Options
TOMO	-	4			/LC/E

2 = 2' (24W/18W/12W)
 4 = 4' (48W/36W/24W)
 8 = 8' (96W/72W/48W)

Blank = 3000K/3500K/4000K/5000K

Blank = White

Blank = 0-10V Dimming,
 120-277V

Blank = No Option
 /LC = Lightcloud® Control
 /LCB = Lightcloud® Blue Enabled
 /LCBS = Lightcloud® Blue Enabled w/PIR Sensor
 /PIR = Passive Infrared Occupancy Sensor
 /E = Battery Backup¹
 /LC/E = Lightcloud® Control w/Battery Backup¹
 /LCB/E = Lightcloud® Blue Enabled w/Battery Backup
 /LCBS/E = Lightcloud® Blue Enabled w/PIR Sensor and Battery Backup
 /PIR/E = Passive Infrared Sensor w/Battery Backup¹

¹ *Available only for 4' and 8'