

# Welcome



Lightcloud®

## Wireless Occupancy Sensor

SENSE/PIR/W/LCB

WE'RE HERE TO HELP:

1(844) LIGHTCLOUD

1(844) 544-4825

# Hello

Lightcloud Blue Wireless Occupancy Sensor is a passive infrared motion detector used to switch lights on/off or dim them. It is compatible with all Lightcloud Blue-enabled lighting and easy to configure using the Lightcloud Blue mobile app.

# Specifications

## PART NUMBER

SENSE/PIR/W/LCB

## MOUNTING HEIGHT

8 to 12 ft.

## SENSOR COVERAGE

20 ft. diameter at 9 ft.

## Wireless Range

60 ft.

## DETECTION ANGLE

120°~150°(adjustable)

## BATTERY TYPE

CR2 3V 850mAh

## PRODUCT DIMENSIONS

2.21"W x 2.30"H x 2.21"D

## PRODUCT WEIGHT

about 0.16lb (73g)

## WORKING HUMIDITY

≤95%RH (no condensation)

## Environment

Indoor

## OPERATING TEMPERATURE

14°F to 122°F (-10°C to 50°C)

## What's in the Box

- 1 Wireless Occupancy Sensor with battery
- 3 Screw sets
- 1 Base adhesive
- 1 installation guide

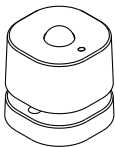

# Function

The Lightcloud Blue Wireless Occupancy Sensor can detect the movement of people or animals in a given area and activate Lightcloud Blue-enabled lighting when motion is detected.

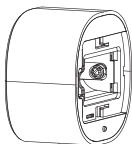

Product body



Battery



Bottom cover

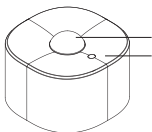

Lens

Distribution network indicator/  
Brightness sensor window

Wake/Reset button

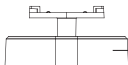
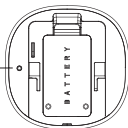

Base

# Installation Environment

- ① This product is only suitable for indoor use. Outdoor installation is prohibited.
- ② Do not install near areas with strong airflows such as fans, air conditioners, etc. otherwise the repeated air disturbance will cause false motion detection.
- ③ Do not install near heat sources such as direct sunlight, heaters, stoves, etc.
- ④ Do not place large obstacles such as screens, furniture, large plants, etc inside the detection range.

# Installation Instructions

- ① Access the battery compartment and remove the spacer.

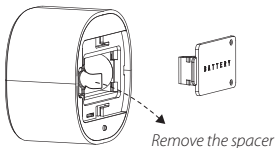

- 2 Attach the base: Snap it onto the product body by aligning the connection points and clicking into a locked position.

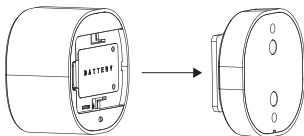

- 3 Mount to a wall using the enclosed adhesive and/or screws.

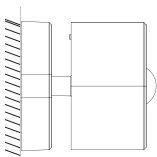

- 3a If Using Adhesive: Select a smooth, clean surface free of rust, oil, dust, etc.
- 3b Remove red film from the adhesive and affix to the surface of the Sensor base. Apply even pressure to ensure proper contact is made across the entire surface of the base.

3c

Remove the red adhesive film and mount the sensor in the desired location. Apply even pressure when mounting to ensure proper contact is made across the surface of the base and mounting surface.

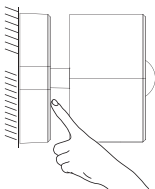

*Note:*

*It can take up to 72 hours for adhesive to reach maximum strength. During this time, do not touch the Sensor or surrounding area. For best results, ambient temperature should be above 50°F (10°C).*

# Quick Setup

- 1 Download the Lightcloud Blue app from the Apple® App Store or Google® Play store.



- 2 Launch the App and login or create an account.



- 3 Wake up the sensor:  
Press and release the Wake/Reset button once  
*(the blue indicator light on the front of the sensor will begin flashing).*

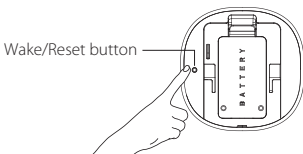

- 4 Add the sensor to your app by selecting the "Devices" tab and, within 30 seconds of waking the sensor, tap "Add Devices" to pair the sensor. Once paired, the sensor will appear in the "Devices" tab.
- 5 Open the sensor device settings in the app by tapping on the sensor card.
- 6 When prompted in the app, wake up the sensor.

- 7 Select "Move to Area" and move the sensor into the desired "Area" (*the sensor must be moved into the same "Area" as the lights you want to control*).
- 8 Under "Areas", tap on the Area with the sensor. In the "Behaviors" section there will be a section labeled "Sensor Settings". Select Occupancy or Vacancy to enable the sensor for the Area and configure sensitivity levels, timeouts and actions.

*Note:*

*Multiple sensors in an Area will act in unison unless the sensor is set to 'Independent Sensing' in the device settings.*

*The sensor settings will take priority over Schedules or SmartShift. To use a sensor with SmartShift, the "When Occupied" sensor setting should be set to "On" and SmartShift "Automatic Dimming" should be enabled.*

## Reset

### Method 1: Delete from App

Open the app and access the device settings for the paired device. Be sure that the sensor is awake and select "Delete".

### Method 2: Manual

Press the Wake/Reset button for more than 5 seconds until the indicator light on the front of the sensor flashes blue.





# Lightcloud®

Lightcloud Blue is a Bluetooth mesh wireless lighting control system that allows you to control RAB's various compatible devices. With RAB's patent-pending Rapid Provisioning technology, devices can be quickly and easily commissioned for residential and large commercial applications using the Lightcloud Blue mobile app. Each device in a system can communicate with any other device, eliminating the need for a Gateway or Hub and maximizing the control system's reach.

Learn more at [www.rablighting.com](http://www.rablighting.com)

# RAB®

©2023 RAB LIGHTING Inc.  
Made in China  
Pat. [rablighting.com/ip](http://rablighting.com/ip)

1(844) LIGHTCLOUD  
1(844) 544-4825

WE'RE HERE TO HELP:

**1(844) LIGHTCLOUD**

1(844) 544-4825

[support@lightcloud.com](mailto:support@lightcloud.com)