



Color: Black/white

Weight: 0.4 lbs

<b>Project:</b>	<b>Type:</b>
<b>Prepared By:</b>	<b>Date:</b>

Driver Info		LED Info	
Type	Constant Current	Watts	12W
120V	0.11A	Color Temp	Field Adjustable
208V	N/A		2700K/3000K/3500K/4000K/5000K
240V	N/A	Color Accuracy	90 CRI
277V	N/A	L70 Lifespan	50,000 Hours
Input Watts	12W	Lumens	950-1,060 lm
		Efficacy	79-88 lm/W

**Technical Specifications**

**Performance**

**Description:**

4-inch LED downlight module for HALED

**Product Type:**

Recessed Downlights

**L70 Lifespan:**

50,000-Hour LED lifespan based on IES LM-70 results

**Dimming:**

Yes, See Dimmer Compatibility List

**Electrical**

**Driver:**

120V, 60 Hz, 0.11A

**THD:**

≤20%

**Power Factor:**

0.9

**Input Voltage:**

120V.

For 120-277V applications, order with [HAD4/D10](#) (sold separately).

**Operating Frequency:**

60 Hz

**LED Characteristics**

**Color Temperature:**

Field Adjustable: 2700K,3000K,3500K,4000K,5000K

**Color Stability:**

LED color temperature is warrantied to shift no more than 200K in color temperature over a 5-year period

**Color Uniformity:**

RAB's range of Correlated Color Temperature follows the guidelines of the American National Standard for Specifications for the Chromaticity of Solid State Lighting (SSL) Products, ANSI C78.377-2017.

**Construction**

**Downlight Module Component:**

This component must be ordered with the 4" HALED trim in order to make a complete fixture.

[See here for Round & Square 4" HALED Trims](#)

**Material:**

Metal

**Trim Style:**

Smooth Trim

**Shape:**

Round

**Mounting:**

Recessed ceiling

**Operating Temperature Range:**

-20°C - 40°C (-4°F - 104°F)

**IC Rated:**

Suitable for direct contact with insulation.

Type IC inherently protected, suitable for direct contact to air permeable insulation and cULus listed for damp locations.

Not for use in direct contact with spray foam insulation, consult NEMA LSD57-2013.

**Expose to UV Light:**

Yes

**Compliance**

**UL Listed:**

Suitable for wet locations

**Energy Star Approved:**

This product is ENERGY STAR® Version 2.2 Certified.

**FCC:**

Complies with Part 15B of the FCC Rules

**California Title 24 JA8 Compliant:**

Can be used to conform with the requirements of California Title 24 Part 6

**Technical Specifications (continued)**

**Air Tight:**

Airtight per ASTM-E283-04

**Trade Agreements Act Compliant:**

This product is a product of Cambodia and a "designated country" end product that complies with the Trade Agreements Act

**Other**

**Warranty:**

RAB warrants that our LED products will be free from defects in materials and workmanship for a period of five (5) years from the date of delivery to the end user, including coverage of light output, color stability, driver performance and fixture finish. RAB's warranty is subject to all terms and conditions found at [rablighting.com/warranty](http://rablighting.com/warranty).

**Note:**

All values are typical (tolerance +/- 10%)

**Buy American Act Compliance:**

RAB values USA manufacturing! Upon request, RAB may be able to manufacture this product to be compliant with the Buy American Act (BAA). Please contact customer service to request a quote for the product to be made BAA compliant.

**Dimensions**

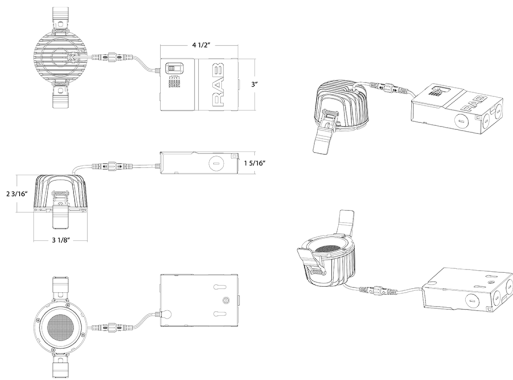

**Features**

- 45-degree optical lens provides uniform light distribution
- Dimmable, see Dimmer Compatibility List
- IC and airtight rated
- Separate snap-in color trims available in round, square, smooth and baffle for in-field installation
- 50,000-Hour LED lifespan
- 5-Year, no compromise warranty

## Ordering Matrix

Family	Size	Shape	CRI/Color Temp	Driver	Dimming
HA	4				

4 = 4"  
6 = 6"

**Blank = Round**   **Blank = 90 CRI, CCT CCT Adjustable**   **Blank = 120V Driver**   **Blank = TRIAC**