



Project:	Type:
Prepared By:	Date:

Driver Info		LED Info	
Type	Constant Current	Watts	9/12/16W
120V	.13A	Color Temp	3000K/3500K/4000K/5000K
208V	.08A	Color Accuracy	90 CRI
240V	.07A	L70 Lifespan	50,000 Hours
277V	.06A	Lumens	800/1100/1500 lm
Input Watts	9/12/16W	Efficacy	89/88/94 Lm/W lm/W

Technical Specifications

Performance

Product Type:

Commercial Downlight

Description:

Wattage and CCT selectable commercial downlights for new construction and retrofit applications.

Wattage Equivalency:

16W CFL
18W CFL
32W CFL

Input Wattage:

9/12/16W

Lumens (Nominal):

9W: 3000K @ 872lm; 3500K @ 900lm; 4000K @ 907lm; 5000K @ 904lm
12W: 3000K @ 1,128lm; 3500K @ 1,170lm; 4000K @ 1,180lm; 5000K @ 1,167lm
16W: 3000K @ 1,578lm; 3500K @ 1,658lm; 4000K @ 1,677lm; 5000K @ 1,636lm

Efficacy:

9W:3000K @ 105lm/W; 3500K @ 109lm/W; 4000K @ 110lm/W; 5000K @ 110lm/W
12W: 3000K @ 105lm/W; 3500K @ 109lm/W; 4000K @ 111lm/W; 5000K @ 109lm/W
16W:3000K @ 101lm/W; 3500K @ 106lm/W; 4000K @ 108lm/W; 5000K @ 105lm/W

L70 Lifespan:

50,000-Hour LED lifespan based on IES LM-70 results

Electrical

Driver:

Constant Current, Class 2, 60 Hz, 120V-277V, 120V: 0.13A, 208V: 0.08A, 240V: 0.07A, 277V: 0.06A

Dimming Driver:

Driver includes dimming control wiring for 0-10V dimming systems. Requires separate 0-10V DC dimming circuit. Dims down to 10%.

THD:

≤20%

Power Factor:

≥0.9

Dimmable:

Yes, 0-10V dims down to 10%. See Dimmer Compatibility List.

Input Voltage:

120-277V

Operating Frequency:

50/60Hz

Input Current @ 120V (mA):

130mA

Input Current @ 208V (mA):

75mA

Input Current @ 240 (mA):

65mA

Input Current @ 277 (mA):

60mA

Operating Temperature:

-4°F to 104°F (-20°C to 40°C)

Flicker:

≤30%

Color Temperature:

Field Adjustable via dip switch
3000/3500/4000/5000K

LED Characteristics

Color Accuracy (CRI):

>90 CRI

R9 Value:

High color performance with R9 greater than or equal to 50

Technical Specifications (continued)**Color Consistency:**

4-step MacAdam Ellipse binning to achieve consistent fixture-to-fixture color

Color Stability:

LED color temperature is warrantied to shift no more than 200K in color temperature over a 5-year period

Color Uniformity:

RAB's range of Correlated Color Temperature follows the guidelines of the American National Standard for Specifications for the Chromaticity of Solid State Lighting (SSL) Products, ANSI C78.377-2017.

Installation**Mounting:**

Recessed

Construction**Size:**

6"

Shape:

Round

Finish:

White

Enclosure Material:

Aluminum

Trim Style:

Smooth

Lens:

Polycarbonate light diffuser distributes light evenly and smoothly for general lighting applications

IC Rated:

Suitable for direct contact with insulation

Air Tight:

Housing certified Air Tight as per ASTM E283

Compliance**Listings:**

UL Listed, UL Classified

Environment:

Suitable for use in dry, damp, and wet environments.

Energy Star Approved:

This product is ENERGY STAR® Version 2.2 Certified

Model Number for Certification:

CRLEDFA-6R-16S-9CCT-UNV-WS

T20 Compliant:

Not Compliant

California Title 24 JA8 Compliant:

Can be used to conform with the requirements of California Title 24 Part 6

California Energy Commission (CEC) Status:

Lawful for Sales in California

NEC Compliant:

Suitable for use in closets. Compliant with NEC Sec. 410.16 (A)(1) and 410.16 (C5).

IESNA LM-79 & lm-80 Testing:

RAB LED luminaires and LED components have been tested by an independent laboratory in accordance with IESNA lm-79 and lm-80

RoHS:

Mercury and UV free. RoHS-compliant components.

FCC:

Complies with Part 15B of the FCC Rules

Trade Agreements Act Compliant:

This product is a product of Cambodia and a "designated country" end product that complies with the Trade Agreements Act

Other**Accessories:**

[DLPLATE/C3468R/NB DLPLATE/WFR3468/NB](#)

Mounting Plate w/nailer bar

[DL6-8GOOF/R/P/CRLEDFA](#)

Commercial Downlight 6"-8" Goof Ring

[DLTRIM/CRLEDFA6R-BNS](#)

6" Smooth Brushed Nickel Color Trim

[DLTRIM/CRLEDFA6R-BRS](#)

6" Smooth Bronze Color Trim

[DLTRIM/CRLEDFA6R-BS](#)

6" Smooth Black Color Trim

[DRI-25-EMGR-DC](#)

Emergency Back up Driver

Warranty:

RAB warrants that our LED products will be free from defects in materials and workmanship for a period of five (5) years from the date of delivery to the end user, including coverage of light output, color stability, driver performance and fixture finish. RAB's warranty is subject to all terms and conditions found at rablighting.com/warranty.

Note:

All values are typical (tolerance +/- 10%)

Buy American Act Compliance:

RAB values USA manufacturing! Upon request, RAB may be able to manufacture this product to be compliant with the Buy American Act (BAA). Please contact customer service to request a quote for the product to be made BAA compliant.

Dimensions

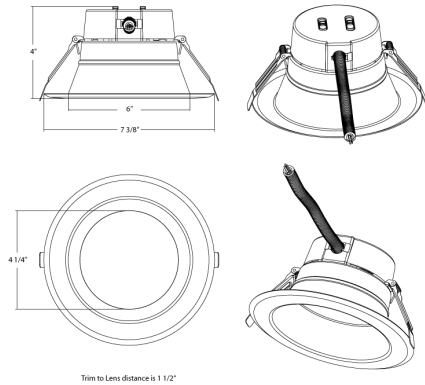

Features

- Mounts directly into ceiling, no housing required
- Field-adjustable "set and forget" color temperature
- High-performance LEDs for commercial applications
- Meets air-tight requirements
- 0-10V dimming, see Dimmer Compatibility List
- Suitable for wet and damp locations
- Replacement for traditional compact fluorescent recessed downlights

Ordering Matrix

Family	Size	Shape	Wattage	CRI/Color Temp	Voltage	Finish	Trim	Options
CRLEDFA	6	R	16S	9CCT	UNV	W	S	
	4 = 4" 6 = 6" 8 = 8" 10 = 10"	R = Round	12S = 12/9/7W Selectable 16S = 16/12/9W Selectable 22S = 22/16/11W Selectable 24S = 24/19/15W Selectable 33S = 33/29/25W Selectable 43S = 43/37/32W Selectable	9CCT = 90 CRI, 3000K/3500K/4000K/5000K	UNV = 120/277V, 0-10V Dimming	W = White	S = Smooth	Blank = No Option /E = Battery Backup