

# Welcome



Lightcloud<sup>®</sup>

## Commercial Downlight

C6R189SSUNVW/LC

WE'RE HERE TO HELP:

**1(844) LIGHTCLOUD**

1(844) 554-4825

# Hello

Lightcloud is a wireless lighting control service. The Lightcloud Lamp is an intelligent lamp that connects wirelessly to a Lightcloud system to provide switching, dimming and scene control.

## Product Features

Wireless Control & Configuration

Zone Switching & Dimming

Human centric light spectrum

Power monitoring

CCT change

Smart shift ready

CRI : 95

0-10V Dimming

# Caution

- Risk of electrical shock. Disconnect power at fuse or circuit breaker before installing or servicing.
- No user serviceable parts inside. To avoid electrical shock do not disassemble product.
- Risk of fire or electric shock, LED Retrofit Kit installation requires knowledge of luminaires electrical systems. If not qualified, do not attempt installation. Contact a qualified electrician.
- Risk of fire or electric shock, Install this kit only in luminaires that have the construction features and dimensions shown in the Figure 9 and where the input rating of the retrofit kit does not exceed the input rating of the luminaire.
- Do not make or alter any open holes in an enclosure of wiring or electrical components during kit installation
- To prevent wiring damage or abrasion, do not expose wiring to edges of sheet metal or other sharp objects.
- THE RETROFIT KIT IS ACCEPTED AS A COMPONENT OF A LUMINAIRE WHERE THE SUITABILITY OF THE COMBINATION SHALL BE DETERMINED BY AUTHORITIES HAVING JURISDICTION. PRODUCT MUST BE INSTALLED BY A QUALIFIED ELECTRICIAN IN ACCORDANCE WITH THE APPLICABLE AND APPROPRIATE ELECTRICAL CODES. THE INSTALLATION GUIDE DOES NOT SUPERSEDE LOCAL OR NATIONAL REGULATIONS FOR ELECTRICAL INSTALLATIONS.
- This device is not intended for use with emergency exists.
- Installers should examine all parts that are not intended to be replaced by the retrofit kit for damage and replace any damaged parts prior to installation of the retrofit kit.
- CAUTION - RISK OF FIRE. CONSULT A QUALIFIED ELECTRICIAN TO ENSURE CORRECT BRANCH CIRCUIT CONDUCTOR
- TYPE IC
- INHERENTLY PROTECTED

WE'RE HERE TO HELP:

**1(844) LIGHTCLOUD**

1(844) 554-4825

# What's in the box



Downlight (1)



MC connector (1)



Wire Nuts (5)



Lumi Sticker (1)



Template (1)



Installation guide(1)

## Tools needed

This Lightcloud downlight requires very few tools for installation. A screwdriver and a pair of curecutters will help to install the downlight to a JBox or housing.

## Luminaire dimension

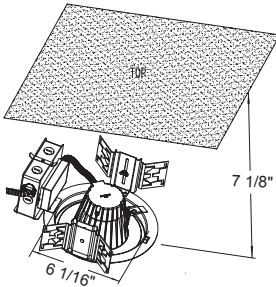

## Optional accessories

### Goof Ring



DL6-8GOOF/R/P  
For use with 8" ceiling hole applications

### Plate

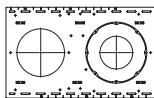

DLPLATE/T  
New construction or remodel plate for T-grid ceilings

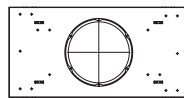

DLPLATE/SJ  
New construction plate for Stud/Joist

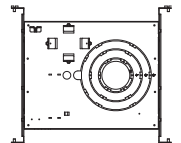

DLPLATE/C3468R/NB  
Mounting plate with nailer bar

# What You Need

## Finding a suitable location

Lightcloud uses a wireless mesh network to connect devices such as the Lightcloud Lamp to the Gateway. Unlike a WiFi router, each Lightcloud device may connect another device to the network. If there is a clear line of sight between two Lightcloud devices, they can be placed up to 1000 feet apart. If the two devices are separated by ordinary drywall construction, try to keep them within 100 feet of each other. Brick, concrete and steel construction may require additional AC-powered Lightcloud devices to go around the obstruction. See the Deployment section of your Gateway for more information.

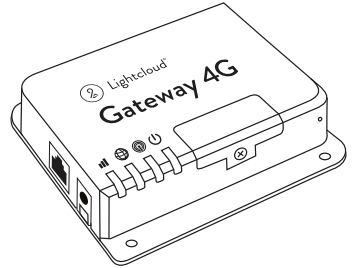

# Setup & Installation

## ① Turn off power

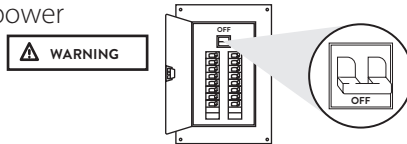

## ② Install the Lightcloud downlight

### 2a With Existing Frame

1. Remove CFL, Incandescent or HID lamp. (Fig.1)
2. Remove reflector from rough-in (mounting frame). (Fig.2)
3. Remove socket assembly from reflector. (Fig.3)

Fig. 1

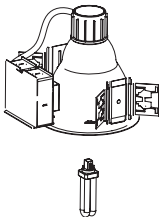

Fig. 2

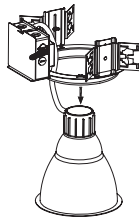
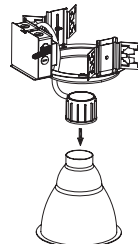

Fig. 3



# Setup & Installation (cont'd)

4. Remove J-Box metal plate with existing lamp ballast. Do not dispose. Disconnect all wires from the ballast. (Fig.4)
5. Remove the existing lamp metal conduit (MC) cable from the J-Box. (Fig.5)

Fig: 4

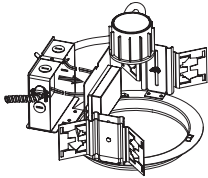
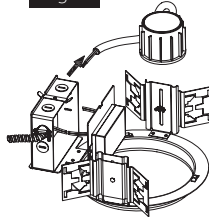

Fig: 5



6. Fasten the LED retrofit kit MC cable to the J-Box with MC connector.(Fig.6)
7. Wire nut the ground (green) wire in the junction box. Wire nut the black input wire with the black wire from the MC cable and wire nut the white input wire with the white wire from the MC cable. Wire nut the purple input wire with the purple wire from the MC cable and wire nut the grey input wire with the grey wire from the cable. If the purple and grey wires are not in use, cap separately each wire with a wire nut. (Fig.7)

Fig: 6

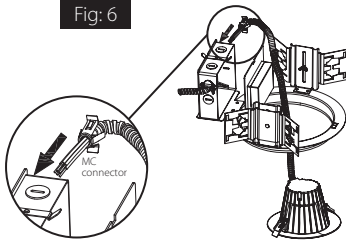
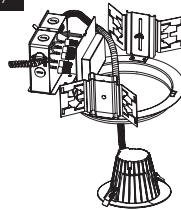

Fig: 7



8. Put back J-Box metal plate (with lamp ballast still attached to it).(Fig.8)
9. Install the retrofit kit in the rough-in by lifting upward both retention tabs. Push the kit until it sits flush against the ceiling. (Fig.9)

Fig: 8

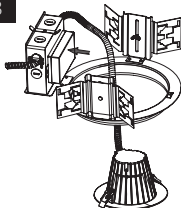
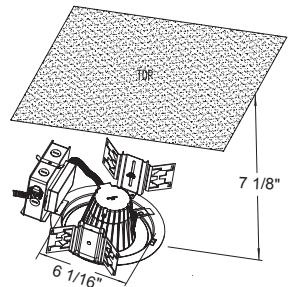

Fig: 9



# Setup & Installation *(cont'd)*

## 2b Without Existing Frame

1. Use template inside box to cut hole in ceiling. *(Fig.10)*

Fig. 10

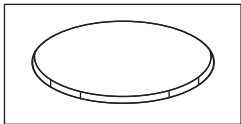

2. Fasten the LED kit MC cable to a junction box with MC connector. Wire nut the ground (green) wire in the junction box. Wire nut the black input wire with the black wire from the MC cable and wire nut the white input wire with the white wire from the MC cable. Wire nut the purple input wire with the purple wire from the MC cable and wire nut the grey input wire with the grey wire from the MC cable. If the purple and grey wires are not in use, cap these with wire nuts. *(Fig.11)*
3. Install junction box cover plate. *(Fig.12)*

Fig. 11

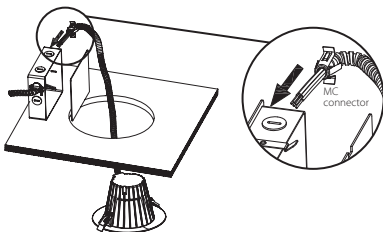
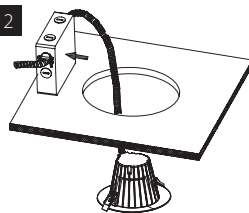

Fig. 12



4. Install the LED kit by lifting both retention tabs upward. *(Fig.13)*
5. Push the kit until it sits flush against the ceiling. *(Fig.14)*

Fig. 13

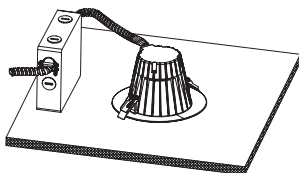
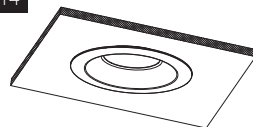

Fig. 14



# Setup & Installation *(cont'd)*

## ③ Pairing the Downlight

After installed in, turn power on and the downlight will enter pairing mode automatically if it has not joined a gateway previously. Once gateway has been joined, lamp will indicate by flashing on and off 5 times and then dim to 30% brightness.

## ④ Resetting the Downlight (Only need when this downlight is provisioned before)

If your Lightcloud downlight is already provisioned before, you can reset the lamp by below method.

### Method 1: 1-10 LAMPS Manual Reset

Power the lamp off and on 5 times consecutively. Do not allow more than 10 seconds and less than 2 seconds to elapse between switching. The lamp will flash 3 times, then reset to 100% brightness at default CCT.



### Method 2: 10+ LAMPS Reset Tool

Reset process must be done by professional electricians qualified by RAB. Reach out to your RAB sales manager to request a Reset Tool. The tool simply needs to be placed directly on the small black Lightcloud logo on downlight for 2 seconds. The lamp will flash 3 times, then reset to 100% brightness at default CCT.



## ⑤ Labeling Your Device

When installing devices, it's important to keep track of their Device IDs, installation locations, panel/circuit #s, dimming function, and any additional notes. To organize this information, use the Lightcloud Installer Application (A) or Device Table (B).

## 5a Lightcloud Installer Application

1. Install the LC Installer Application:  
LC Installer is available for iOS and Android.
2. Scan & Install Lightcloud Devices:  
Scan each device and assign to a room. It's recommended that each device is scanned just before or just after being wired so no devices are missed. The more notes that are given, the easier it is to commission the system.
3. Send to RAB:  
Once all of the devices have been added and organized, submit the information for commissioning.



# Setup & Installation *(cont'd)*

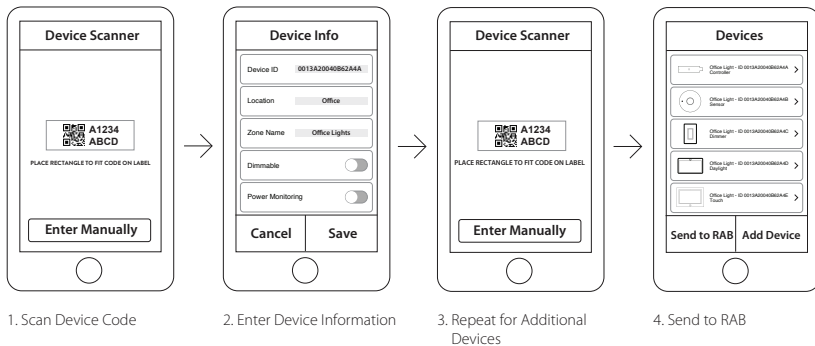

## 5b Device Table

Two Lightcloud Device Tables are provided with each Gateway: one that you can attach to your panel and one to hand off to a building manager. Attach the Device Identification stickers included with each device to a row, then write in additional information, such as Zone name, Panel/Circuit Number, and whether or not a Zone uses dimming.

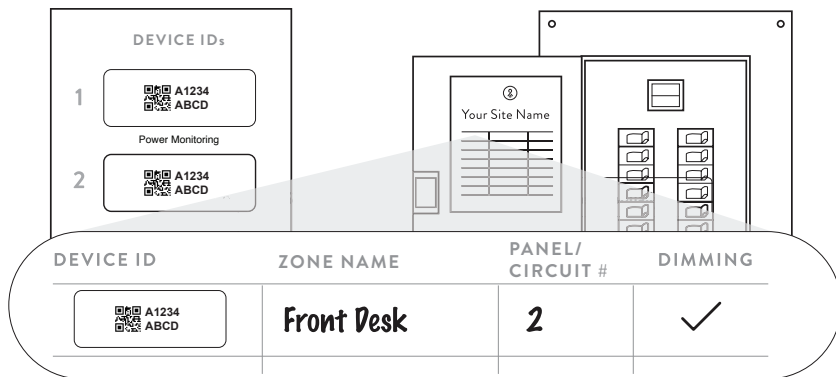

To add devices to your Lightcloud network, call RAB at 1 (844) LIGHTCLOUD, or email us at [support@lightcloud.com](mailto:support@lightcloud.com)

# Functionality

## Configuration

All configuration of Lightcloud products may be performed using the Lightcloud web Application, or by calling RAB.

WE'RE HERE TO HELP:

**1 (844) LIGHTCLOUD**

1 (844) 544-4825

support@lightcloud.com

## Emergency default

If communication is lost, the Controller may optionally fall back to a specific state, such as turning the attached luminaire on. [ Warning: Any wires not in use must be capped off or otherwise insulated. ]

### FCC Information:

This device complies with Part 15 of the FCC Rules. Operation is subject to the following two conditions: 1. This device may not cause harmful interference, and 2. This device must accept any interference received, including interference that may cause Note: This device has been tested and found to comply with the limits for Class B digital devices pursuant to Part 15 Subpart B, of the FCC rules. These limits are designed to provide reasonable protection against harmful interference in a residential environment. This equipment generates, uses, and can radiate radio frequency energy, and if not installed and used in accordance with the instruction manual, may cause harmful interference to radio communications. However, there is no guarantee that interference will not occur in a particular installation. If this equipment does cause harmful interference to radio or television reception, which can be determined by turning the equipment of and on, the user is encouraged to try and correct the interference by one or more of the following measures:

- Reorient or relocate the receiving antenna.
- Increase the separation between the equipment and receiver.
- Connect the equipment into an outlet on a circuit different from that to which the receiver is connected.
- Consult the dealer or an experienced radio/TV technician for help.

To comply with the FCC's RF exposure limits for general population / uncontrolled exposure, this transmitter must be installed to provide a separation distance of at least 20 cm from all persons and must not be co-located or operating in conjunction with any other antenna or transmitter.

CAUTION: Changes or modifications to this equipment not expressly approved by RAB Lighting may void the user's authority to operate this equipment.



Lightcloud is a commercial wireless lighting control system. It's powerful and flexible, yet easy to use and install.

Learn more at [www.lightcloud.com](http://www.lightcloud.com)

**1(844) LIGHTCLOUD**

1(844) 554-4825

**RAB<sup>®</sup>**

©2020 RAB LIGHTING Inc.

Made in China.

Pat. [rablighting.com/ip](http://rablighting.com/ip)

# 排版

正

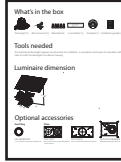
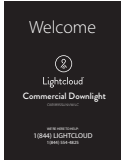

反

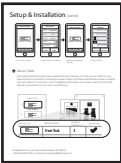
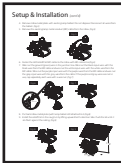

注：此页非1:1