

Color: White

Weight: 3.3 lbs

Project:	Type:
Prepared By:	Date:

Driver Info		LED Info	
Type	Constant Current	Watts	20/16/12W
120V	0.20A/0.15A/0.10A	Color Temp	3000K/4000K/5000K
208V	0.10A/0.08A/0.06A	Color Accuracy	82-84 CRI
240V	0.09A/0.07A/0.06A	L70 Lifespan	100,000 Hours
277V	0.08A/0.07A/0.05A	Lumens	1,174-2,043 lm
Input Watts	11.18-19.32W	Efficacy	93.1-115.7 lm/W

Technical Specifications

Field Adjustability

Field Adjustable:

Field Adjustable Light Output:

20W/16W/12W (factory default 20W)

Color Temperature Selectable:

3000K, 4000K and 5000K (factory default 5000K)

On/Off Photocell (factory default "On")

Performance

Lifespan:

100,000-Hour LED lifespan based on IES LM-80 results and TM-21 calculations

LED Characteristics

LEDs:

Long-life, high-efficacy, discrete, surface-mount LEDs

Electrical

Driver:

Constant Current, Class 1, 120-277V, 50/60 Hz:

20W: 0.20A, 208V: 0.10A, 240V: 0.09A, 277V: 0.08A

16W: 120V: 0.15A, 208V: 0.08A, 240V: 0.07A, 277V: 0.07A

12W: 120V: 0.10A, 208V: 0.06A, 240V: 0.06A, 277V: 0.05A

THD:

20W: 17.7% at 120V, 13.7% at 277V

16W: 17.9% at 120V, 13.7% at 277V

12W: 16.5% at 120V, 12.1% at 277V

Power Factor:

20W: 98.5% at 120V, 93.8% at 277V

16W: 98.4% at 120V, 91.7% at 277V

12W: 98.3% at 120V, 87.4% at 277V

Aux Power Supply:

No

Dim to Off:

No

Photocell:

120-277V selectable photocell that can be turned on and off.

Surge Protection:

2kV

Construction

Cold Weather Starting:

The minimum starting temperature is -40°C (-40°F)

Ambient Temperature:

Suitable for use in up to 45°C (113°F)

Housing:

Die-cast aluminum

Lens:

Glass

Gaskets:

High-temperature silicone

Finish:

Formulated for high durability and long-lasting color

Green Technology:

Mercury and UV free. RoHS-compliant components.

Compliance

UL Listed:

Suitable for wet locations

IESNA LM-79 & LM-80 Testing:

RAB LED luminaires and LED components have been tested by an independent laboratory in accordance with IESNA LM-79 and LM-80.

IP Rating:

Ingress protection rating of IP65 for dust and water

Installation

Mounting:

Wall mount

Technical Specifications (continued)

Optical

BUG Rating:

20W: B1 U3 G1

16W: B1 U3 G1

12W: B1 U3 G1

Other

5 Yr Limited Warranty:

The RAB 5-year, limited warranty covers light output, driver performance and paint finish. RAB's warranty is subject to all terms and conditions found at rablighting.com/warranty.

Buy American Act Compliance:

RAB values USA manufacturing! Upon request, RAB may be able to manufacture this product to be compliant with the Buy American Act (BAA). Please contact customer service to request a quote for the product to be made BAA compliant.

Dimensions

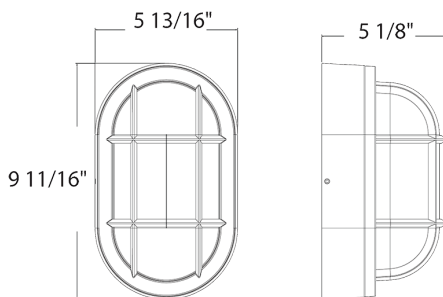

Features

- 100,000-hour LED Life
- On/Off photocell
- 5-Year, limited warranty

Ordering Matrix

Family	Wattage	Color Temp	Shape	Finish	Driver	Options
BULKH	20			W		
	10 = 10/8/6W 15 = 15/12/9W 20 = 20/16/12W	Blank = 3000/4000/5000K CCT Adjustable	Blank = Oval R = Round	Blank = Bronze W = White	Blank = 120-277V	Blank = On/Off Photocell