

Color: Black

Weight: 13.0 lbs

Project:	Type:
Prepared By:	Date:

Driver Info	LED Info
Type	Constant
120V	1.67A/1.50A/1.33A
208V	0.96A/0.87A/0.77A
240V	0.83A/0.75A/0.67A
277V	0.72A/0.65A/0.58A
Input Watts	188/172/152.9W
Watts	200/180/160W
Color Temp	3000K
Color Accuracy	82 CRI
L70 Lifespan	100,000 Hours
Lumens	28,037/26,098/23,658 lm
Efficacy	149.1/151.7/154.7 lm/W

### Technical Specifications

#### Field Adjustability

**Field Adjustable:**  
Field Adjustable Light Output:  
200W/180W/160W (factory default: 200W)

#### Compliance

**UL Listed:**  
Suitable for wet locations. Suitable for mounting within 4ft (1.2m) of the ground.

**IESNA LM-79 & LM-80 Testing:**  
RAB LED luminaires and LED components have been tested by an independent laboratory in accordance with IESNA LM-79 and LM-80.

**IP Rating:**  
Ingress protection rating of IP66 for dust and water

**DLC Listed:**  
This product is listed by Design Lights Consortium (DLC) as an ultra-efficient premium product that qualifies for the highest tier of rebates from DLC Member Utilities. Designed to meet DLC 5.1 requirements.  
DLC Product Code: S-CLH3P5

**LUNA:**  
This product has received the Design Lights Consortium's LUNA listing for 3000K Models. Designed to meet LUNA 5.1 requirements.  
LUNA Product Code: S-CLH3P5

#### Performance

**Lifespan:**  
100,000-Hour LED lifespan based on IES LM-80 results and TM-21 calculations

**THD:**  
3.3% at 120V, 4.44% at 277V

**Wattage Equivalency:**  
200W: Replaces up to 750W Metal Halide (MH) or 400W High Pressure Sodium (HPS)  
180W: Replaces up to 750W Metal Halide (MH) or 400W High Pressure Sodium (HPS)  
160W: Replaces up to 750W Metal Halide (MH) or 400W High Pressure Sodium (HPS)

#### Electrical

**Driver:**  
Constant Current, Class 1, 120-277V, 50/60 Hz:  
150W: 120V: 1.25A, 208V: 0.72A, 240V: 0.63A, 277V: 0.54A  
120W: 120V: 1.0A, 208V: 0.58A, 240V: 0.5A, 277V: 0.43A  
100W: 120V: 0.83A, 208V: 0.48A, 240V: 0.42A, 277V: 0.36A

**Dimming Driver:**  
Driver includes dimming control wiring for 0-10V dimming systems. Requires separate 0-10V DC dimming circuit. Dims down to 10%.

**Power Factor:**  
99.9% at 120V, 96.5% at 277V

**7-Pin Receptacle with Shorting Cap:**  
ANSI C136.41 7-pin receptacle, compatible with wireless control systems

**Surge Protection:**  
6kV

#### Construction

**IES Classification:**  
The Type V distribution produces light in a wide and uniform 360° pattern that is perfect for large outdoor areas such as parking lots, corporate parks and retail settings

**Cold Weather Starting:**  
The minimum starting temperature is -40°C (-40°F)

**Maximum Ambient Temperature:**  
Suitable for use in up to 40°C (104°F)

**Lens:**  
Polycarbonate lens

**Housing:**  
Die-cast aluminum

## Technical Specifications (continued)

### Effective Projected Area:

1 Fixture: 0.4  
2 Fixtures: 0.8  
3 Fixtures: 1.4  
4 Fixtures: 1.4

### Finish:

Formulated for high durability and long-lasting color

### Gaskets:

High-temperature silicone gaskets

### Green Technology:

Mercury and UV free. RoHS-compliant components.

## LED Characteristics

### LEDs:

Long-life, high-efficacy, surface-mount LEDs

### Color Uniformity:

RAB's range of Correlated Color Temperature follows the guidelines of the American National Standard for Specifications for the Chromaticity of Solid State Lighting (SSL) Products, ANSI C78.377-2017.

## Installation

### Mounting:

Non-Adjustable universal pole mount

## Optical

### BUG Rating:

Type 5  
200W: B5 U0 G3  
180W: B4 U0 G2  
160W: B4 U0 G2

## Other

### 5 Yr Limited Warranty:

The RAB 5-year, limited warranty covers light output, driver performance and paint finish. RAB's warranty is subject to all terms and conditions found at [rablighting.com/warranty](http://rablighting.com/warranty).

### Buy American Act Compliance:

RAB values USA manufacturing! Upon request, RAB may be able to manufacture this product to be compliant with the Buy American Act (BAA). Please contact customer service to request a quote for the product to be made BAA compliant.

Dimensions

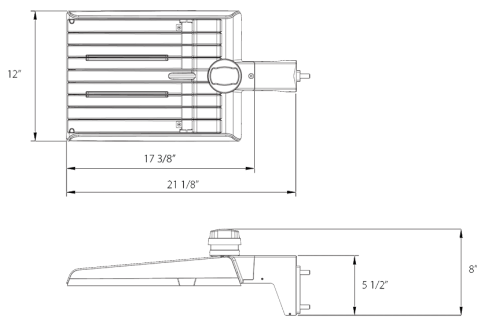

Features

- DLC Premium listed
- Luna Listed
- Non-Adjustable Universal Pole Mount
- 7-Pin Receptacle with Shorting Cap
- IP66 Rated
- 100,000-Hour LED lifespan
- 5-Year, limited warranty

Ordering Matrix

Family		Optics	Wattage	Mounting	Color Temp	Finish	Driver	Options
A22	-	5T	200	Blank	Y	B		
		2T = Type II	70 = 70/60/50W	Blank = Universal Adjustable Pole Mount	Blank = 3000/4000/5000K CCT Adjustable	Blank = Bronze	Blank = 120-277V, 0-10V Dimming	Blank = 7-Pin Receptacle with Shorting Cap
		4T = Type IV	100 = 100/80/60W					
		5T = Type V	150 = 150/120/100W	Blank = Universal Non-Adjustable Pole Mount	Y = 3000K	W = White	/480 = 480V, 0-10V Dimming	/MVS = 7-Pin Receptacle with Shorting Cap and Microwave Motion Sensor
		Blank = Type III	200 = 200/180/160W					
			320 = 320/280/250W			B = Black		/LCBS = Lightcloud Blue w/PIR Sensor
								/LCBS/MVS = Lightcloud Blue w/MVS Sensor