

WhisperFresh Select™ Fresh Air Supply Fan

WhisperFresh Select™
VENTILATION FAN

FV-15NLFS1



- Customizable fresh air supply fan featuring Pick-A-Flow™ technology – one fan, you choose the CFM (50-60-70-80-90-100-110-130-150 in CFM; 9 settings)
- Intelligent ECM motor with SmartFlow technology provides optimum CFM output for precision whole-house supply ventilation
- Operates as a stand-alone filtered supply fresh air solution to meet ASHRAE 62.2 requirements for make-up/supply air
- Capable of communicating with Panasonic's acclaimed WhisperGreen® Select™ to create a balanced ventilation solution
- Incorporates adjustable high humidity and low temperature dials for easy adjustments in any climate zone
- HVI certified for use with MERV 8 (FL0815NL1) and MERV 13 (FV-FL1315NL1) filters. MERV 8 filter included, MERV 8 and MERV 13 replacements available
- Can be used to comply with ASHRAE 62.2, LEED and CA Title 24

ADDITIONAL BENEFITS

- Can be used in conjunction with SelectCycler System™ to create a wired, measurable balanced ventilation solution
- Can be used as a re-circulation filtration device in the home
- Can be used to create slight positive pressure within the home instead of using a Central HVAC
- Excellent fresh air solution in combination with ductless HVAC solutions
- Designed for use in conjunction with furnace blower in Combustion Appliance Zone (CAZ) depressurization situations
- Easy installation in new construction or retrofits



Installed Performance



ECM Motor with SmartFlow™ Technology

WhisperFresh Select™ is designed to perform as rated. When the fan senses static pressure, its speed is automatically increased to ensure optimal CFM output. This feature provides peace of mind, as the installer doesn't have to worry about compromising the fan's performance, even with a complicated duct run.



Pick-A-Flow™ Speed Technology

Built-in Pick-A-Flow speed selector provides the unique ability to select your required airflow (50-150 CFM, in 10 CFM increments) with the simple turn of a dial.

Optional Built-In Controls



Reset Button – Convenient light indicator and unobtrusive alarm signal on the access panel help inform the homeowner when it's time to check and clean the (MERV 8/MERV 13) filter. Button resets every time customer changes filter.



CFM – Can be selected for 50/60/70/80/90/100/110/130/150 CFM (9 settings).



Humidity Setting – Customized fresh air supply based on humidity conditions of incoming air. Fan will automatically shut off (or not turn on) when the outside relative humidity is higher than the setting on the humidity dial (from 30% to 80% RH).



Temperature Setting – Customized low temperature setting will shut fan off when incoming supply air is too cold. Fan will turn off (or not turn on) when the outside temperature is lower than the setting value. (From 15°F to 40°F). Fan automatically stops operating when the incoming air is higher than 95°F.



FV-15NLFS1

FV-15NLFS1

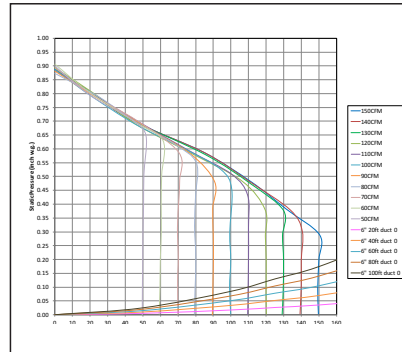

FV-15NLFS1

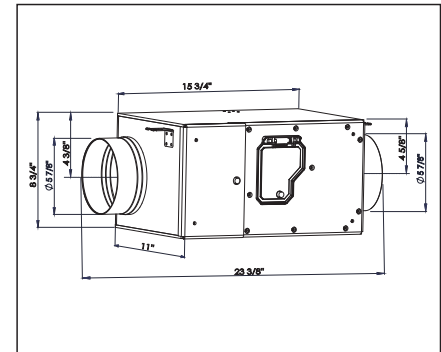

Specifications		WhisperFresh Select™ 6" Duct										
		FV-15NLFS1										
Characteristics (HVI tested data for 0.1" S.P.)	Static Pressure in inches w.g.	0.2										
	Air Volume (CFM)	150	140	130	120	110	100	90	80	70	60	50
	Power Consumption (watts)	27.3	24.8	22.6	19.4	16.7	15.3	13.5	12.4	10.0	9.3	8.2
	Energy Efficiency (CFM/Watt)	5.59	5.97	6.30	6.72	7.05	7.45	7.61	7.83	7.64	7.58	7.40
	Speed (RPM)	1314	1265	1235	1201	1152	1121	1086	1067	1033	1012	989
	Current (amps)	0.41	0.26	0.33	0.29	0.25	0.23	0.20	0.18	0.16	0.15	0.13
	MAX. Current (amps)	0.46										
	Power Rating (V/Hz)	120/60										
Specifications	Motor Type	ECM										
	Type of Motor Bearing	Ball										
	Thermal Fuse Protection	N/A (Electronically-Protected Limited)										
	Blower Wheel Type	Sirocco										
	ENERGY STAR Qualified	Yes										
Installation	Duct Diameter (Inches)	6"										
	Power Cord Included	Integrated 5.8 foot power cord										
Shipping	Gross Weight (lbs)	17.4 (7.9kg)										
Approved Code/Standard/Regulation	UL tub/Shower Enclosure	N/A										
	Washington VIAQ Code	Yes										
	Wall installation	No										
	California Title 24 Compliant	Yes										
	Mfg in ISO 9001 Certified Facility	Yes										
RoHS Compliant	Yes											

Specifications		WhisperFresh Select™ 6" Duct										
		FV-15NLF51										
Characteristics (HVI tested data for 0.1" S.P.)	Static Pressure in inches w.g.	0.3										
	Air Volume (CFM)	150	140	130	120	110	100	90	80	70	60	50
	Power Consumption (watts)	32.0	29.0	25.0	23.0	20.0	18.0	15.0	14.0	13.0	11.0	10.0
	Energy Efficiency (CFM/Watt)	4.68	4.82	5.20	5.21	5.50	5.55	6.00	5.71	5.38	5.45	5.00
	Speed (RPM)	-	-	-	-	-	-	-	-	-	-	-
	Current (amps)	0.46	0.42	0.38	0.34	0.31	0.28	0.25	0.22	0.21	0.18	0.16
	MAX. Current (amps)	0.46										
	Power Rating (V/Hz)	120/60										
Specifications	Motor Type	ECM										
	Type of Motor Bearing	Ball										
	Thermal Fuse Protection	N/A (Electronically-Protected Limited)										
	Blower Wheel Type	Sirocco										
	ENERGY STAR Qualified	Yes										
Installation	Duct Diameter (Inches)	6"										
	Power Cord Included	Integrated 5.8 foot power cord										
Shipping	Gross Weight (lbs)	17.4 (7.9kg)										
Approved Code/Standard/Regulation	UL tub/Shower Enclosure	N/A										
	Washington VIAQ Code	Yes										
	Wall installation	No										
	California Title 24 Compliant	Yes										
	Mfg in ISO 9001 Certified Facility	Yes										
	RoHS Compliant	Yes										

Specifications		WhisperFresh Select™ 6" Duct										
		FV-15NLF51										
Characteristics (HVI tested data for 0.1" S.P.)	Static Pressure in inches w.g.	0.4										
	Air Volume (CFM)	130	130	130	120	110	100	90	80	70	60	50
	Power Consumption (watts)	29.0	29.0	28.0	26.0	24.0	21.0	19.0	17.0	15.0	14.0	12.0
	Energy Efficiency (CFM/Watt)	4.48	4.48	4.64	4.61	4.58	4.76	4.73	4.70	4.66	4.28	4.16
	Speed (RPM)	-	-	-	-	-	-	-	-	-	-	-
	Current (amps)	0.43	0.43	0.42	0.39	0.36	0.32	0.29	0.26	0.24	0.22	0.21
	MAX. Current (amps)	0.46										
	Power Rating (V/Hz)	120/60										
Specifications	Motor Type	ECM										
	Type of Motor Bearing	Ball										
	Thermal Fuse Protection	N/A (Electronically-Protected Limited)										
	Blower Wheel Type	Sirocco										
	ENERGY STAR Qualified	Yes										
Installation	Duct Diameter (Inches)	6"										
	Power Cord Included	Integrated 5.8 foot power cord										
Shipping	Gross Weight (lbs)	17.4 (7.9kg)										
Approved Code/Standard/Regulation	UL tub/Shower Enclosure	N/A										
	Washington VIAQ Code	Yes										
	Wall installation	No										
	California Title 24 Compliant	Yes										
	Mfg in ISO 9001 Certified Facility	Yes										
	RoHS Compliant	Yes										



Panasonic Eco Solutions of North America
Eco Products Division
 Two Riverfront Plaza
 Newark, NJ 07102
us.panasonic.com/ventfans

For Order Information
 PHONE: 866-292-7299
 FAX: 888-553-0723
ventfans@us.panasonic.com