

NX-606-LED

Die-Cast LED Exit Signs with Battery Backup

Source: 2.3W

Type _____

Project _____

Catalog No. _____

Notes _____

PRODUCT DESCRIPTION

Nora Lighting's compact, low profile LED exit signs are as brilliant and visible as standard incandescent signs, yet use a fraction of the power. LED light sources require no maintenance for 25 years—saving greatly on maintenance and upkeep costs. Nora Lighting's LED exits are ideal for commercial and industrial standard non-emergency applications where low maintenance and operating costs are a must.

Die-cast exit sign utilizing Light Emitting Diode (LED) modules as the primary light source for economy operation. Exit sign includes a backup NiCad battery for 90 minute operation under emergency applications where primary power source has been interrupted or terminated.

ELECTRICAL

Voltage: 120V or 277V dual input

Wattage: 2.3W

Light Source: LED

Operating Temperature: 10°C to 40°C (50°F to 104°F)

Circuitry Protection: Short circuit protection. Brown-out protection.

Construction: Brushed, die-cast aluminum, low profile, snap-together housing constructed of 20 gauge steel. Snap-out knock-outs for wiring.

Face: Two front faces sent with dual face unit, One face plate sent with single face unit. 6" high text with color diffusion.

Mounting: Exit sign can be mounted on a wall, side or ceiling mounted (all mounting hardware included).

Battery: Replaceable Ni-Cad battery offers 90 minute emergency operation on fully charged battery.

Testing: High-charge / ready operation indicator light and test button.

LABELS AND LISTINGS

- UL Listed
- NFPA
- NEC
- [5-Year Limited Warranty](#)
- Certified to the energy efficiency standards of California Title 20



PRODUCT IMAGES AND DIMENSIONS

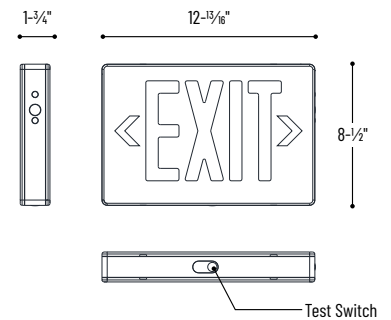

Die-Cast LED Exit Signs with Battery Backup

Catalog No.	Letter Color	Faces	Housing Color
NX-606-LED	/R = 6" Red Letters	(blank) = Single Face	(blank) = Black Housing
	/G = 6" Green Letters	/2F = Double Faces	

Replacement Battery

Description
NEB-NICAD6 = Replacement Ni-Cad Battery for NX-606-LED/R
NEB-NICAD7 = Replacement Ni-Cad Battery for NX-606-LED/G

Example: **NX-606-LED/R** = 6" Red Letters Die-Cast LED Exit Sign with Battery Backup, Single Face, Black Housing