

# NM4-RDC

## 4" M4 Round LED Recessed Downlight

Source: 15W LED  
1100lm

### PRODUCT DESCRIPTION

4" M4 Round LED downlight are ideal for remodel or new constructions in residential and light commercial applications. IC Air-Tight rated luminaires require no housing, making installation easy.

### FEATURES

- No housing required - IC Air-Tight rated
- Easy installation for remodel or new construction applications
- Square trim available for an alternative appearance
- Quick disconnect allows for extended lengths
- 2700K or 3000K @ 90+ CRI
- Triac or ELV dimming
- 5-year limited warranty
- ENERGY STAR certified
- cETLus Listed for Wet Locations

### SPECIFICATION

**Construction:** Die-cast aluminum trims available in matte black or matte powder white finish. Optional field changeable square trim is available.

**Air Flow Restriction:** Luminaire has factory installed gasket to restrict airflow from room into ceiling plenum to <2CFM (cubic feet per minute) in accordance with ASTM-283 Air-Tight requirements.

**Clearance:** IC rated luminaires are rated for direct contact with insulation (not spray foam insulation), no minimum clearance is required.

**Junction Box:** Prewired junction box includes quick connect to LED fixtures for ease of installation. Junction box includes four 1/2" trade size knockouts and snap on cover with 7" quick connect wire. Luminaire includes 6 1/2" quick connect wire.

**Mounting:** No housing is required, two tensions steel spring clips secure luminaire to ceiling. Accommodates ceiling thickness up to 3/4". New construction frame-ins are available, see mounting accessories.

### ELECTRICAL

**Input Voltage:** 120V  
**Lumens / Wattage:** 1100lm / 15W  
**Color Temperature:** 2700K or 3000K  
**Color Rendering Index:** 90+CRI  
**Beam Spread:** 37° Narrow Flood  
**Operating Temp.:** 0°C to 25°C ambient temperature  
**Lifetime:** 50,000 hours @ L70  
**Dimming:** Dimmable down to 10% with Triac or ELV  
[Click Here](#) or check complete dimmer list at [www.NoraLighting.com](http://www.NoraLighting.com) in the "Compatibility" page under "Resources" tab

### OPTIONAL TRIM ACCESSORIES

**NM4-SDT:** Square Baffle Trim for NM4-RDC, Black or White

### OPTIONAL MOUNTING ACCESSORIES

**NF-R375:** New Construction Frame-In  
**NFC-R375:** New Construction Frame-In with collar  
**NM2-EW-4:** 4' Quick Connect Linkable Extension Cable  
**NM2-EW-10:** 10' Quick Connect Linkable Extension Cable

### LABELS AND LISTINGS

- cETLus Listed for Wet Locations
- ENERGY STAR certified
- [5-Year Limited Warranty](#)
- FCC compliant
- Certified to the high efficacy requirements of California Title 24 JA8-2022



Type \_\_\_\_\_

Project \_\_\_\_\_

Catalog No. \_\_\_\_\_

Notes \_\_\_\_\_

### Performance Data

Part Number	Lumens	CCT
<b>NM4-RDC27BB</b>	1027lm	2700K
<b>NM4-RDC27MPW</b>	1086lm	2700K
<b>NM4-RDC30BB</b>	1086lm	3000K
<b>NM4-RDC30MPW</b>	1177lm	3000K

### PRODUCT IMAGES AND DIMENSIONS

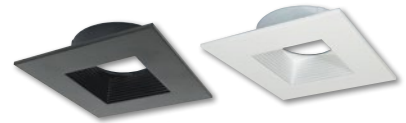
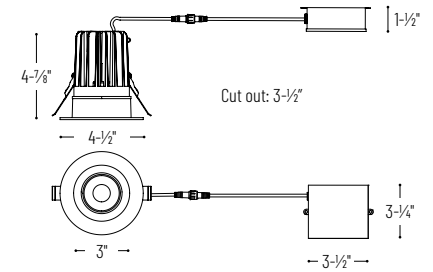

**NM4-SDT**  
Square Baffle Trim

## 4" M4 Round LED Recessed Downlight

Trim Type	Color Temperature	Finish
<b>NM4-RDC</b> = 4" Round Downlight	<b>27</b> = 2700K	<b>BB</b> = Matte Black
	<b>30</b> = 3000K	<b>MPW</b> = Matte Powder White

### NM4-RDC Trim Accessories

Accessory Type	Finish
<b>NM4-SDT</b> = Square Baffle Trim	<b>B</b> = Matte Black <b>MPW</b> = Matte Powder White

## Optional Mounting Accessories

Accessory Type
<b>NF-R375</b> = New Construction Frame-In Plate
<b>NFC-R375</b> = New Construction Frame-In with collar
<b>NM2-EW-4</b> = 4' Quick Connect Extension Cable
<b>NM2-EW-10</b> = 10' Quick Connect Extension Cable

Example: **NM4-RDC30MPW** = 4" M4 Round LED Recessed Downlight, 1100lm / 15W, 3000K / 90 CRI, Matte Powder White

# NM4-RDC

## 4" M4 Round LED Recessed Downlight Accessories

Type	_____
Project	_____
Catalog No.	_____
Notes	_____



Square Trim for NM4-RDC

**NM4-SDTB** Matte Black  
**NM4-SDTMPW** Matte Powder White  
Converts the round trim included with NM4-RDC downlight into a square trim



New Construction Frame-In

**NF-R375**  
For new construction pre-wiring and easier layout planning.



New Construction Frame-In with Collar

**NFC-R375**  
For new construction pre-wiring and easier layout planning.



Quick Connect Extension Linkable Cables

**NM2-EW-4** 4' Cable  
**NM2-EW-10** 10' Cable  
Use to extend the length between luminaire and driver enclosure. Can be connected together to create custom lengths. Maximum length between luminaire and driver is 40'.

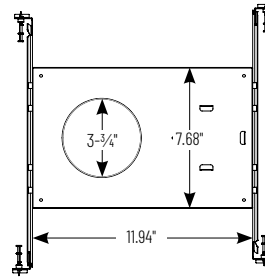
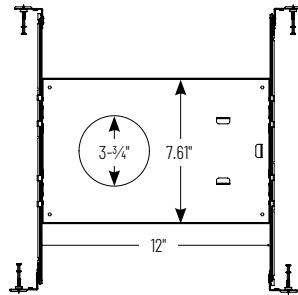

# PHOTOMETRICS

## NM4-RDC

### 4" M4 Round LED Recessed Downlight

Type

Project

Catalog No.

Notes

#### Test Information

Test Number: NTR1853R1  
 Part Number: NM4-RDC27MPW  
 Beam Spread: 36° Narrow Flood  
 Lumens: 1086lm  
 Wattage: 14.33W  
 Efficacy: 76lpw  
 CCT / CRI: 2700K / 90 CRI  
 Spacing Criteria (0°-180°): 0.60  
 Spacing Criteria (90°-270°): 0.58

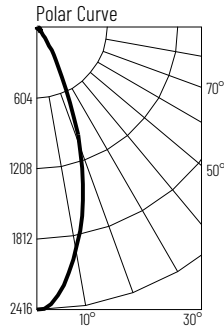

#### Illuminance at a Distance

Distance from Luminaire	FC at Nadir	Beam Diameter
4'	151fc	2'-7"
6'	67.1fc	3'-11"
8'	37.8fc	5'-2"
10'	24.2fc	6'-6"
12'	16.8fc	7'-10"

#### Zonal Lumen Summary

Zone	Lumens	% Luminaire
0-30	884	81.4
0-40	988	90.9
0-60	1061	97.7
0-90	1086	100
90-180	0	0
0-180	1086	100

#### Candela Table

Vertical Angles	Candela
0	2416
5	2227
15	1481
25	596
35	163
45	48

#### Test Information

Test Number: NTR1855R1  
 Part Number: NM4-RDC30MPW  
 Beam Spread: 37° Narrow Flood  
 Lumens: 1177lm  
 Wattage: 14.41W  
 Efficacy: 82lpw  
 CCT / CRI: 3000K / 90 CRI  
 Spacing Criteria (0°-180°): 0.62  
 Spacing Criteria (90°-270°): 0.6

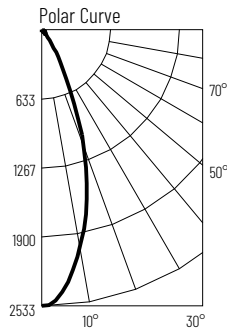

#### Illuminance at a Distance

Distance from Luminaire	FC at Nadir	Beam Diameter
4'	158fc	2'-8"
6'	70.4fc	4'
8'	39.6fc	5'-5"
10'	25.3fc	6'-8"
12'	17.6fc	8'-1"

#### Zonal Lumen Summary

Zone	Lumens	% Luminaire
0-30	954	81
0-40	1068	90.8
0-60	1149	97.6
0-90	1177	100
90-180	0	0
0-180	1177	100

#### Candela Table

Vertical Angles	Candela
0	2533
5	2386
15	1610
25	660
35	187
45	52

#### Finish Multiplier

Finish: Black (x0.93), Matte Powder White (x1.0)