

# NLOPAC-R6REGT24

6" Regressed AC Opal, LED Surface Mount

Source: 13W LED

Up to 950lm

Type

Project

Catalog No.

Notes

## PRODUCT DESCRIPTION

Regressed AC Opal Series fixture is designed to surface mount over a standard junction box. Regressed light source gives the appearance of a recessed luminaire.

## FEATURES

- Recessed appearance
- AC LED (No Driver)
- 2700K, 3000K or 4000K @ 90+ CRI
- Can be used with recessed housings when used with optional retrofit kit
- ENERGY STAR certified
- cETLus Listed for Wet Locations
- Certified to the high efficacy requirements of California Title 24 JA8-2022

## SPECIFICATION

**Construction:** One piece die-cast aluminum formed luminaire. Aluminum body dissipates heat and extends life.

**Mounting:** Surface mount luminaire is compatible with 3" or 4" junction boxes and 1/2" deep pancake boxes. Luminaires can also be mounted on 5" or 6" recessed housings using optional torsion spring kit (NLOPAC-56RECKIT-2).

**Ratings:** IC rated when used with 3" or 4" electrical junction box rated for direct contact with insulation. Fire rated when used with a fire rated junction box.

## ELECTRICAL

**Input Voltage:** 120V

**Input Frequency:** 50/60Hz

**Lumens / Wattage:** Up to 950lm / 13W

**Color Temperature:** 2700K, 3000K, 4000K

**Color Rendering Index:** 90+ CRI

**Beam Spread:** 114° Wide Flood

**Operating temperature:** -20°C to 40°C

**Dimming:** Triac/ELV

## ACCESSORIES

**NLOPAC-56RECKIT-2:** AC Opal can be mounted in 5" or 6" recessed housings using optional torsion spring kit.



## LISTING

- cETLus Listed for wet locations
- ENERGY STAR certified
- 5-Year Limited Warranty
- Certified to the high efficacy requirements of California Title 24 JA8-2022
- Suitable for use in closets when installed in accordance to NEC Section 410.16 (A)(1) and 410.16 (C)(1).
- FCC Compliant



## Performance Data

Part Number	Lumens	CCT
<b>NLOPAC-R6REGT2427W</b>	809lm	2700K
<b>NLOPAC-R6REGT2430W</b>	881lm	3000K
<b>NLOPAC-R6REGT2440W</b>	969lm	4000K

## PRODUCT IMAGES AND DIMENSIONS

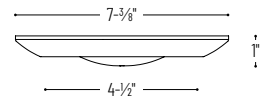
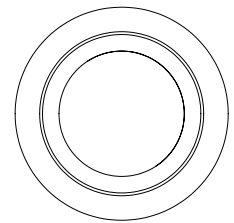

## 6" Regressed AC Opal

Series	Color Temperature	Finish
<b>NLOPAC-R6REGT24</b>	<b>27</b> = 2700K	<b>W</b> = White
	<b>30</b> = 3000K	
	<b>40</b> = 4000K	

## Optional Accessory

Description
<b>NLOPAC-56RECKIT-2</b> = Torsion Spring Kit / Recessed Retrofit Kit

Example: **NLOPAC-R6REGT2427W** = 6" Regressed AC Opal, 2700K, White Finish

# PHOTOMETRICS

## 6" Regressed AC Opal, LED Surface Mount

Type

Project

Catalog No.

Notes

### Test Information

Test Number: NTRG1001  
 Part Number: NLOPAC-R6REGT2427W  
 Beam Spread: 114° Wide Flood  
 Lumens: 809lm  
 Wattage: 12.48W  
 Efficacy: 65lpw  
 CCT / CRI: 2700K / 90 CRI  
 Spacing Criteria (0°-180): 1.26  
 Spacing Criteria (90°-270): 1.26

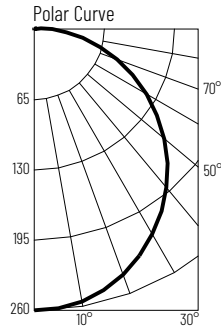

### Illuminance at a Distance

Distance from Luminaire	FC at Nadir	Beam Diameter
4'	16.2fc	12'-6"
6'	7.2fc	18'-10"
8'	4.1fc	25'-1"
10'	2.6fc	31'-4"
12'	1.8fc	37'-7"

### Zonal Lumen Summary

Zone	Lumens	% Luminaire
0-30	201	24.9
0-40	330	40.8
0-60	590	72.9
0-90	792	97.8
90-180	18	2.2
0-180	809	100

### Candela Table

Vertical Angles	Candela
0	260
5	257
15	248
25	230
35	205
45	174

### Test Information

Test Number: NTRG1002  
 Part Number: NLOPAC-R6REGT2430W  
 Beam Spread: 114° Wide Flood  
 Lumens: 881lm  
 Wattage: 13.09W  
 Efficacy: 67lpw  
 CCT / CRI: 3000K / 90 CRI  
 Spacing Criteria (0°-180): 1.26  
 Spacing Criteria (90°-270): 1.26

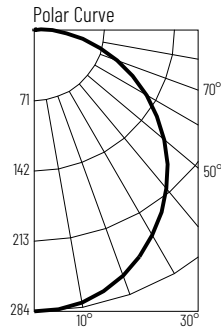

### Illuminance at a Distance

Distance from Luminaire	FC at Nadir	Beam Diameter
4'	17.8fc	12'-6"
6'	7.9fc	18'-10"
8'	4.4fc	25'
10'	2.8fc	31'-4"
12'	2fc	37'-7"

### Zonal Lumen Summary

Zone	Lumens	% Luminaire
0-30	221	25.1
0-40	362	41.1
0-60	646	73.3
0-90	865	98.2
90-180	16	2
0-180	881	100

### Candela Table

Vertical Angles	Candela
0	284
5	283
15	273
25	253
35	225
45	191

### Test Information

Test Number: NTRG1003R1  
 Part Number: NLOPAC-R6REGT2440W  
 Beam Spread: 115° Wide Flood  
 Lumens: 969lm  
 Wattage: 11.67W  
 Efficacy: 83lpw  
 CCT / CRI: 4000K / 90 CRI  
 Spacing Criteria (0°-180): 1.26  
 Spacing Criteria (90°-270): 1.24

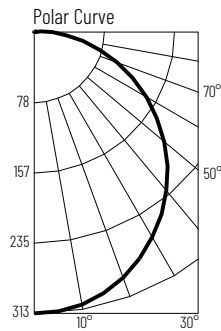

### Illuminance at a Distance

Distance from Luminaire	FC at Nadir	Beam Diameter
4'	19.5fc	12'-7"
6'	8.7fc	18'-10"
8'	4.9fc	25'-1"
10'	3.1fc	31'-5"
12'	2.2fc	37'-8"

### Zonal Lumen Summary

Zone	Lumens	% Luminaire
0-30	243	25.1
0-40	398	41.1
0-60	710	73.3
0-90	950	98.1
90-180	19	1.9
0-180	969	100

### Candela Table

Vertical Angles	Candela
0	312
5	310
15	298
25	277
35	248
45	210