

IC25R 5" Shallow Incandescent Remodel Housing

IC Rated

Juno

AIR-LOC

new

Features

- 5" Shallow Universal IC Remodel housing
- 5 3/4" height for use in 2 x 6 construction
- Floating socket with spring for quick trim attachment and consistent lamp positioning
- Medium base porcelain socket with nickel-plated copper screw shell
- Remodel springs accommodate up to a 1 1/8" ceiling thickness
- Housing is fully assembled for ease of installation
- Pre-wired junction box with (5) 1/2" knockouts with pryout slots, (4) non-metallic sheathed cable connectors, and ground wire
- UL/C-UL Listed for through-branch wiring, maximum (4) #12 AWG branch circuit conductors (2 in, 2 out)
- Thermally protected against improper use of lamps
- Shadow-free, knife-edge trim design blends smoothly into the ceiling and allows architectural continuity with Aculux® trims
- Lamp wattage ratings and apertures based on trim selection on pages 65C



Description

IC rated, energy efficient Air-Loc® sealed remodel shallow housing for applications where the back side of the ceiling is not accessible • Ideal solution for where vertical installation space is limited • Can be completely covered with insulation • Air-Loc installation stops infiltration and exfiltration of air, reducing heating and cooling costs

Listings

UL and C-UL listed for through-branch wiring, damp and wet locations • Wet location listed with 212 trim • The listing also includes the 275 and 276 trims, only when used with outdoor rated PAR lamps • Washington State IECC and MEC energy codes as tested per ASTM-E283 • Conforms with City of Chicago IP requirements

Ordering Information

Catalog Number: **IC25R**

Accessories

Catalog Number	Description
ALG5R	Air-Loc® Energy Conserving Gasket Kit for 5" Air-Loc® IC Remodel housings
SMPLT-5	Galvanized steel plate for locating remodel style housings in new construction. Screw/nail holes for full coverage between 16" and 24" joists.

Dimensions

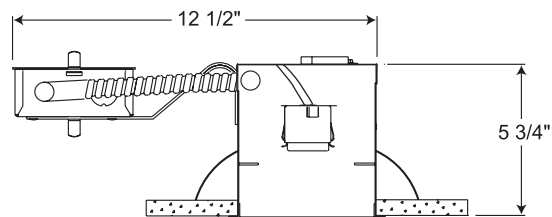
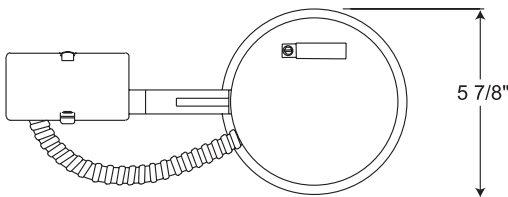

5 1/2" Ceiling Cutout

Down-Lites

JUNO LIGHTING GROUP
by Schneider Electric